

FORMING/CUTTING

R Power Resistors

AVISERT
Type

AVISERT TYPE

This specification is applicable to
1/4W & 1/2Ws of Carbon Film Fixed
Resistors, Metal film Fixed Resistors
and METAL OXIDE FILM Resistor.

$F=2.5\text{MM}$

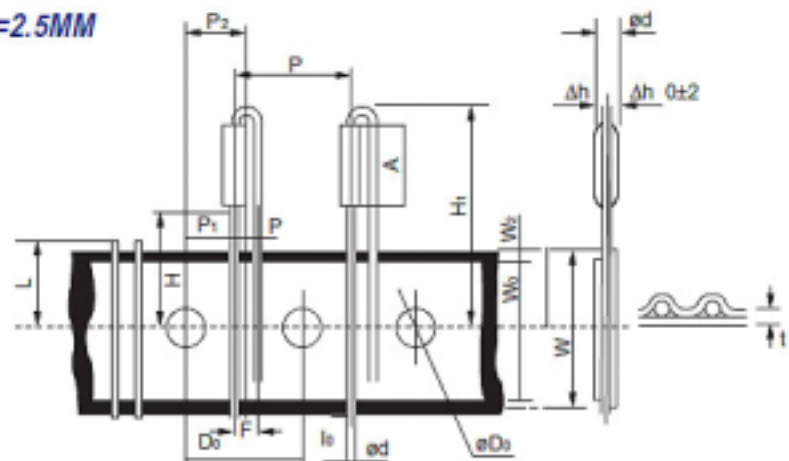

DIMENSION

ITEM	Symbol	Dimension (mm)	Items	Symbol	Deimension (mm)
Body diameter	D	1/4 W 1/2 Ws	2.3max	Hold-down tape width	W_h 13 min.
Body Length	A	1/4 W 1/2 Ws	6.8max	Hole position	W_1 9.0 ± 0.5
Load-wire diameter	d	1/4 W 1/2 Ws	0.6 ± 0.05	Hold down tape position	W_2 1.0 max.
Pitch of component	P		12.7 ± 1	Height of component from tape center	H $18 \pm \frac{2}{0}$
Feed hole pitch	P_0		12.7 ± 0.3	Load-wire clinch height	
Feed hole center to lead	P_1		5.1 ± 0.5	Component height	H_1 28 max.
Lead to lead distance	F		$2.5 \begin{smallmatrix} +0.5 \\ -0.2 \end{smallmatrix}$	Lead-wire protrusion	l_0 1.0 max.
Tape width	W		18.0 ± 1	Feed hole diameter	D_0 4.0 ± 0.3
	P_2		6.35 ± 1	Total tape thickness	t 0.5 ± 0.2

MT Type Forming for Taping
(Rated Watts 1/6W and 1/4Ws)

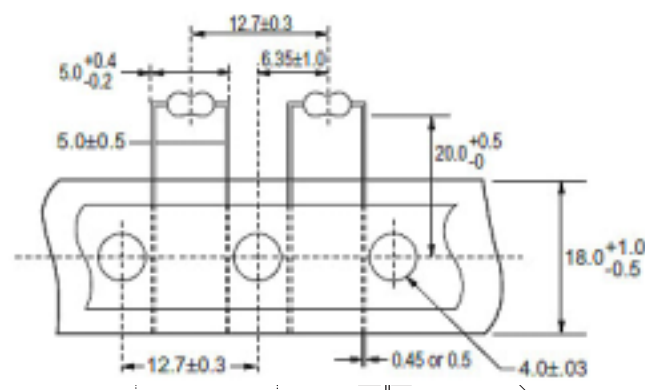

FORMING/CUTTING

R Power Resistors

PANASERT
Series

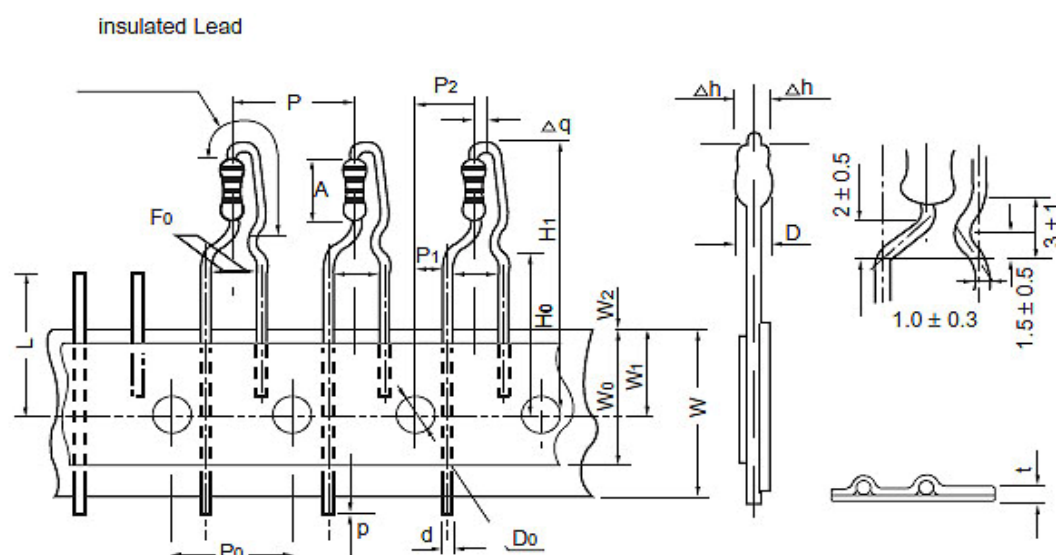

DIMENSION

記 號	寸 法 (mm)	記 號	寸 法 (mm)	記 號	寸 法 (mm)
P	12.70 ± 1.0	W ₀	12.5 Min.	l	0
P ₀	12.70 ± 0.3	W ₁	9 ± 0.5	t	0.70 ± 0.2
P ₁	3.85 ± 0.7	W ₂	1.5 Max.	Δg	0 ± 2.5
P ₂	6.35 ± 1.0	H ₁	32 Max.	Δh	0 ± 2.0
F	5.00 ± 0.8	H ₀	16 ± 0.5	A	$6.35^{+0.65}_{-0.36}$
F ₀	2.50 ± 0.5	D ₀	4 ± 0.2	D	$2.30^{+0.50}_{-0.30}$
W	$18.00^{+1.0}_{-0.5}$	L	11 Max.	d	0.60 ± 0.05

DIMENSION

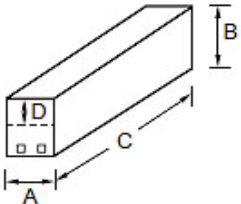
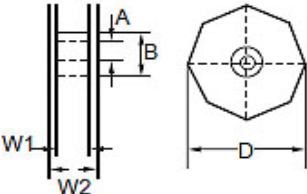
Size	Type	Ammo Packing	Reel Packing	
Figure				
Dimension	A	50 mm	A	30 mm
	B	125 mm	B	50 mm
	C	330 mm	D	370 mm
	D	15 mm	W ₁	41 mm
			W ₂	45 mm
Quantity		2,000 pcs	2,500 pcs	

FORMING/CUTTING

R Power Resistors

AVISERT
Type

$F = 5.0\text{mm}$

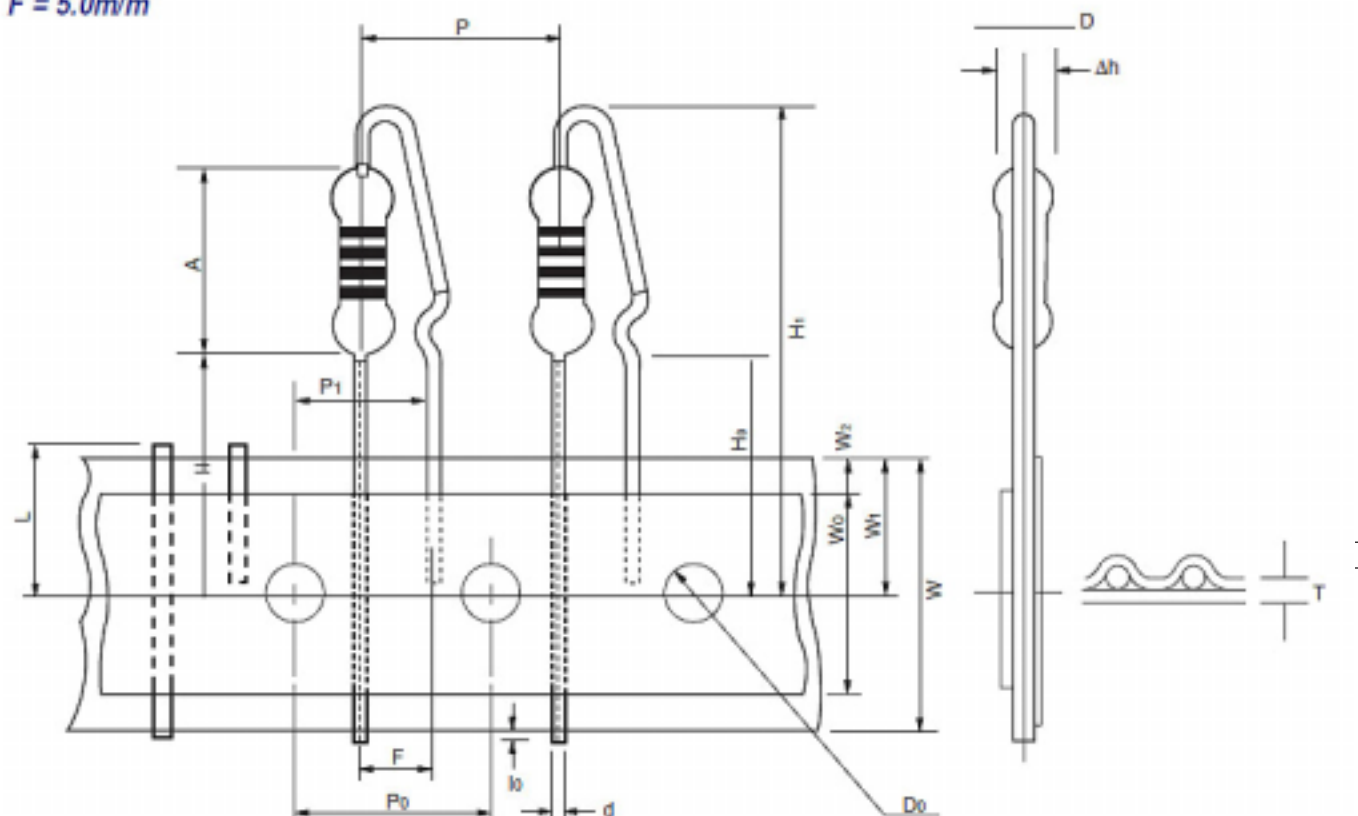

DIMENSION

ITEM	Symbol	Dimension (mm)	Items	Symbol	Dimension (mm)
Body diameter	D 1/4 W 1/2 W _s	2.3max	Hold-down tape width	W ₀	12 min.
Body Length	A 1/4 W 1/2 W _s	6.8max	Hole position	W ₁	9.0 ± 0.5
Lead-wire diameter	d 1/4 W 1/2 W _s	0.6 ± 0.05	Hold down tape position	W ₂	3.0 max.
Pitch of component	P	12.7 ± 1	Height of component from tape center	H	16 ± 0.5
Feed hole pitch	P ₀	12.7 ± 0.3	Lead-wire clinch height	H ₀	16 ± 0.5
Feed hole center to lead	P ₁	3.85 ± 0.7	Component height	H ₁	32.25 max.
Lead to lead distance	F	5 ± 1	Lead-wire protrusion	l ₀	1.0 max.
Tape width	W	18.0 ± 1	Feed hole diameter	D ₀	4.0 ± 0.3
			Total tape thickness	t	0.5 ± 0.2